

zView for the AIO

What is zView?

zView is a presentation tool that allows a teacher to display zSpace content to their class for all to see. The students will view the presented image in 2D and thus will not need glasses. This tool allows two presentation settings:

Standard View

Shows what you see on your screen.

Augmented Reality

View simulates a 3D experience.



Watch these videos to learn more: [How to zView](#) [Installation Instructions](#) [Set-up Instructions](#)

What is included in a zView Kit?

- HDMI-to-VGA adapter
- Webcam
- Articulating arm (armature) to be mounted to side of
- zSpace with bracket
- Bracket with screws
- Allen wrench and nut wrench



FAQ's

Is there an alternative to the armature?

The webcam can be attached to a tripod (not included) as another set-up option.

Does the zView application require a license key?

Yes. If you do not have a license key for zView, contact your zSpace area representative for more information.

Teaching with zView Example Video:

[zSpace Mini-Lesson: Carpel Tunnel using Human Anatomy Atlas](#)

zView use is only available on some applications.

View the [zSpace Software Matrix](#) to determine which applications work with zView.

Need help?

Contact zSpace Support:
support@zspace.com

Use zView to Share your zSpace with an Audience

Shortcuts for zSpace Applications & zView:

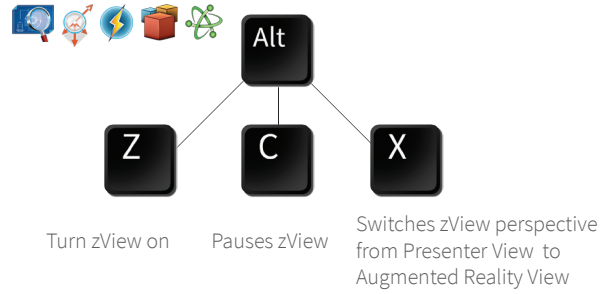

1 +

Set zSpace to extended display.

- Connect to a secondary display.
- Use Windows key and P to enable extended screen.

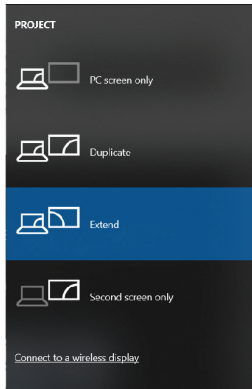

2 Launch the application through zCentral. Select zView.

- Within zSpace Applications click on the zView icon in the Home Control Bar and present.
- In Human Anatomy Atlas , click on the zView icon in the Main Menu.
- In Leopoldy , click on the zView icon in the Main Menu.
- In VIVED , turn on and off via the Settings menu.

3 To switch between Standard and Augmented View
Use zView menu displayed onto secondary screen.

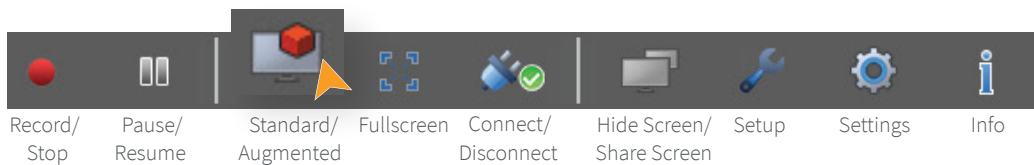

Getting ready to set up AR View

To use Augmented Reality(AR) View, you must set up your camera via the zView application.

Tip: The audience observe a AR demonstration without 3D glasses.

1 Make sure your camera is plugged into the USB port located on the back of your zSpace system.

2 Launch zView from programs menu or within an application.

3 Drag your mouse to the zView image on the extended screen and select the setup tool icon.

Make sure that all four corners of the screen are visible in the camera image. Not all test patterns need to be highlighted green. For more information, visit:

<https://zspace.com/edu/info/zview>